

1

Arrange all parts of the display case side by side.

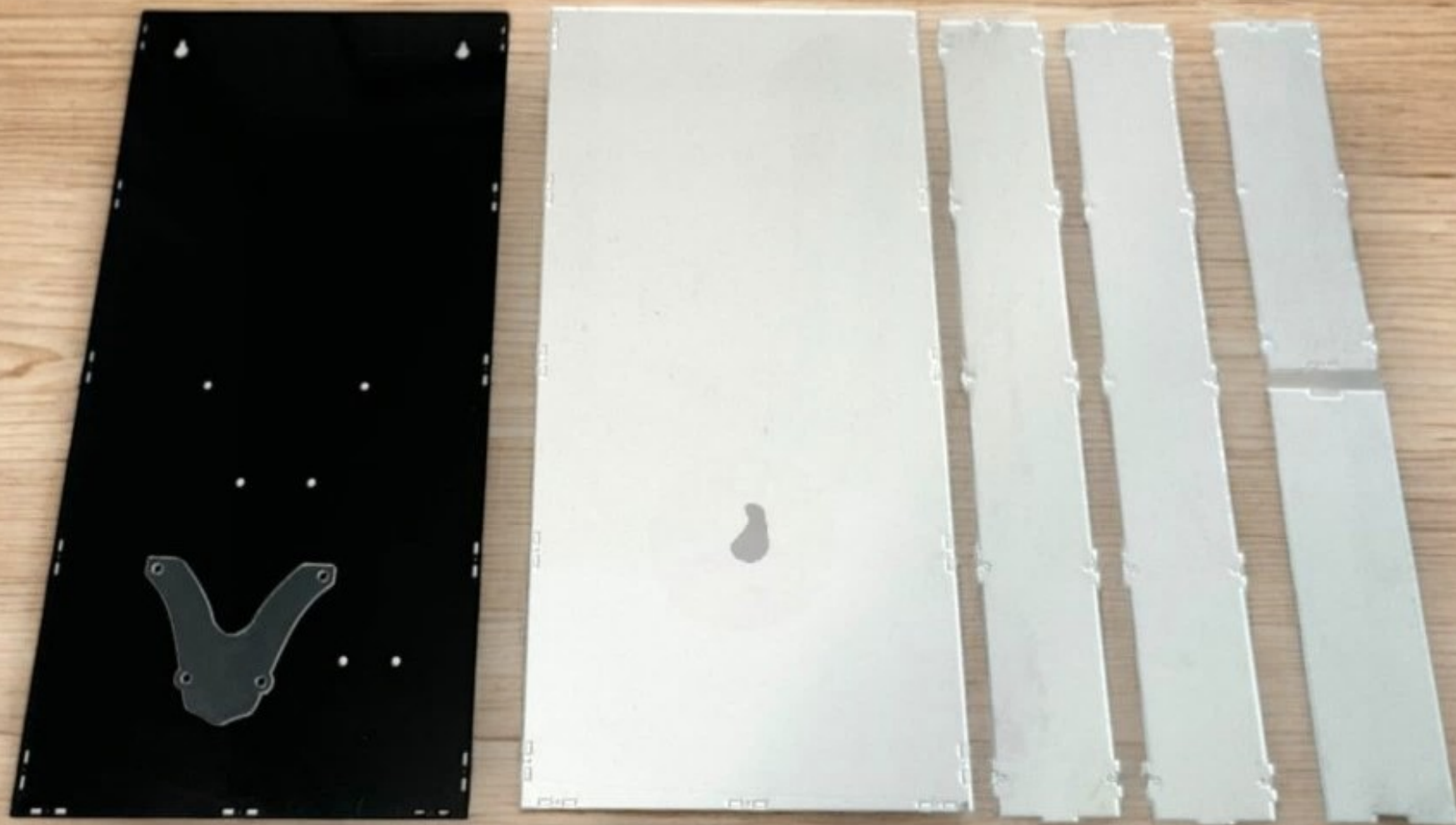

2

Remove protective film from the front side of the black back-panel.



Tip: front side is opposite to the side with the countersunk holes

3

Remove protective film from the acrylic holders!

Note: All transparent parts have a film on both sides.

Next: Connect the holders to the back-panel by using the stainless steel spacers.



- 4** Remove all protective film from the remaining transparent parts.
Exception: Only remove protective film on the inner side of front-panel.

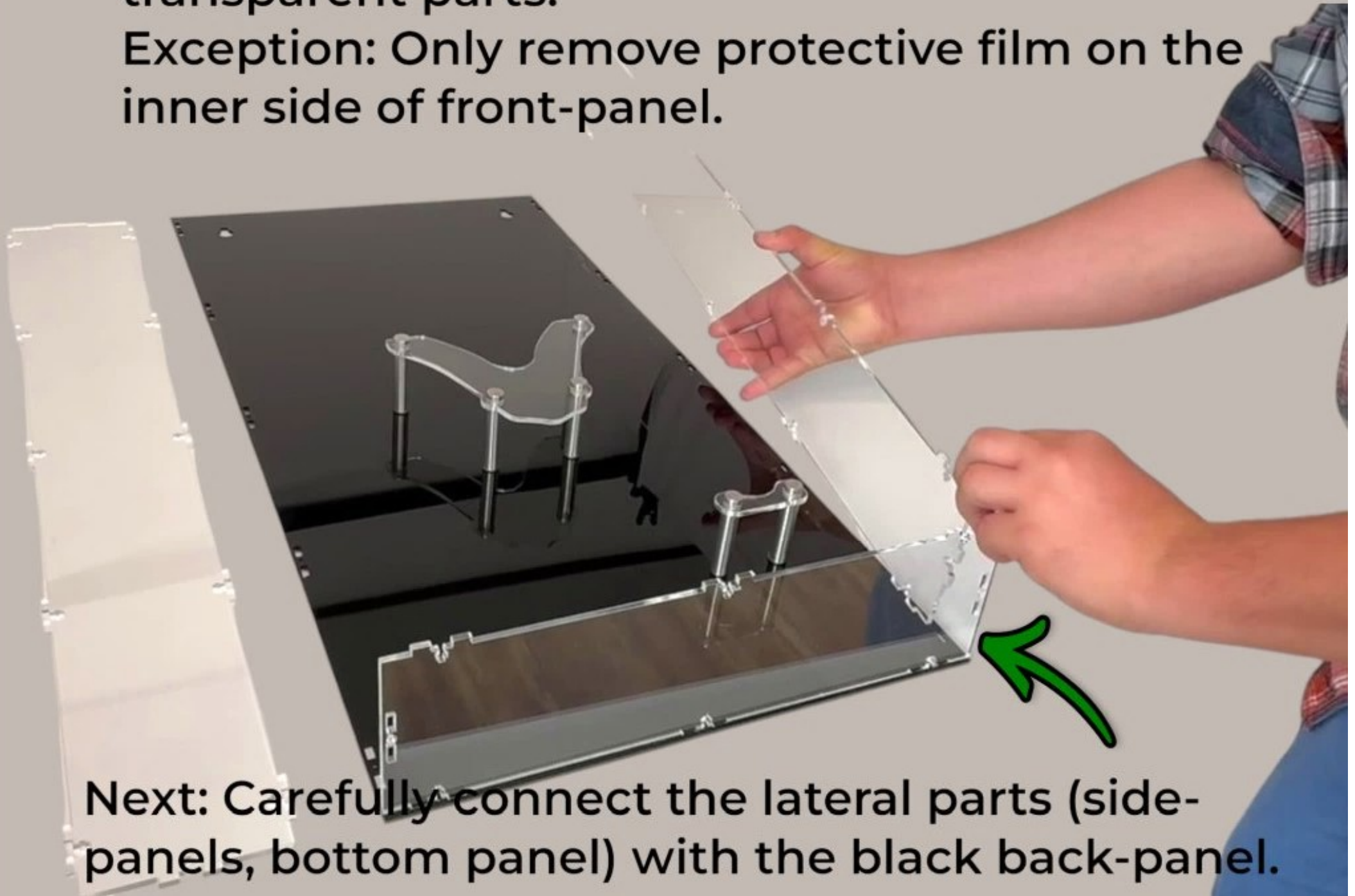

Next: Carefully connect the lateral parts (side-panels, bottom panel) with the black back-panel.

5

Place the front-panel on top of the lateral parts, making sure the side with the countersunk holes is facing upwards.

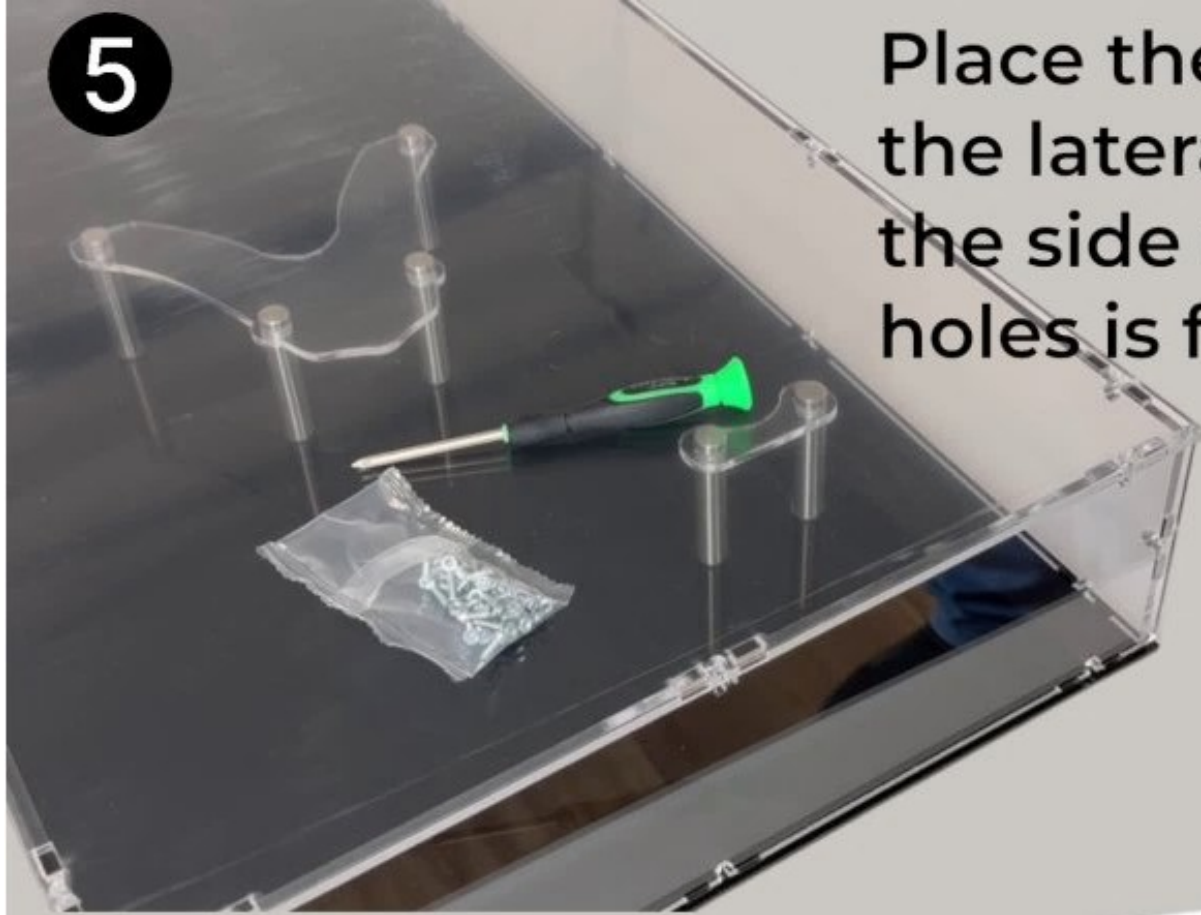

Next: Position the acrylic panels so the pre-drilled holes align. Place a hexagon nut into each connector slot. Use the M2.5 countersunk screws to fasten the panels by tightening them into the nuts.

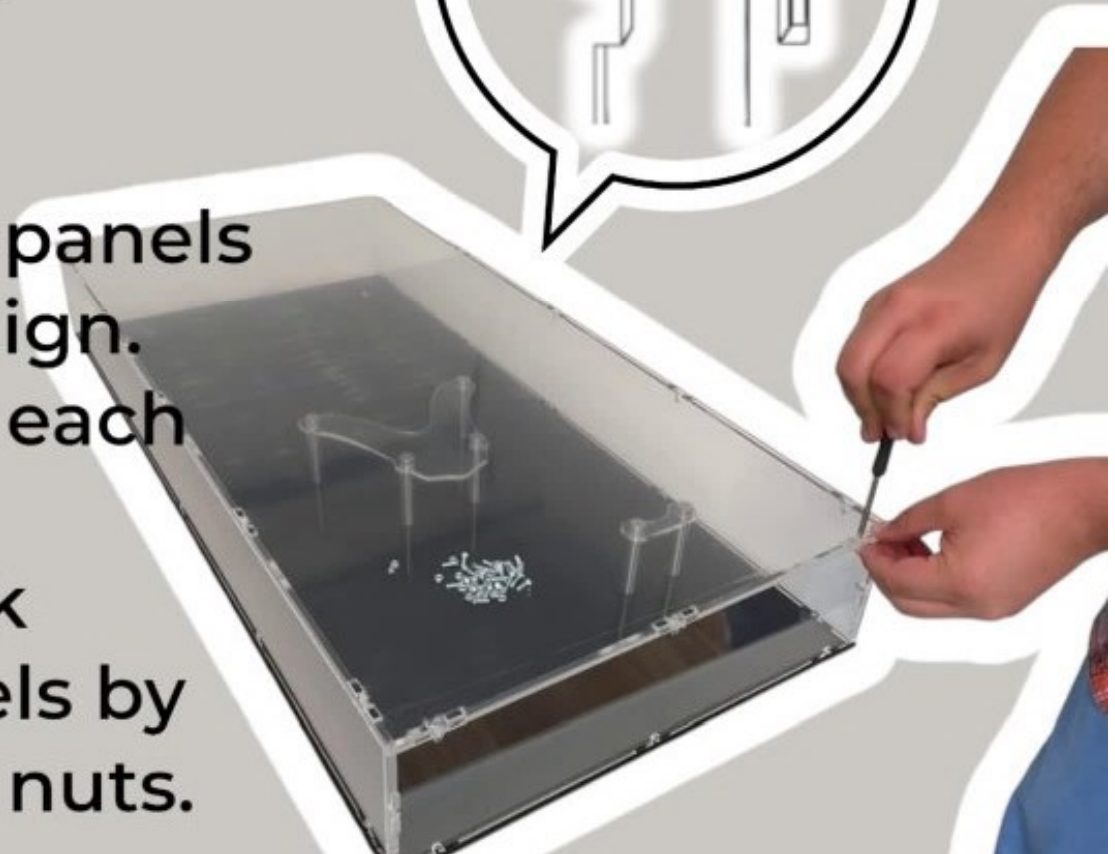

6

Rotate the case and place it with the front-panel facing down. Now place the back-panel on top and fasten it using the countersunk screws and nuts.

Make sure to also insert the screws and nuts that join the bottom with the side-panels.

You can now stand your case upright.



7

Position your tennis ball and tennis racket inside the case.

Tip: Tilt the case slightly to let the ball roll onto its holder.

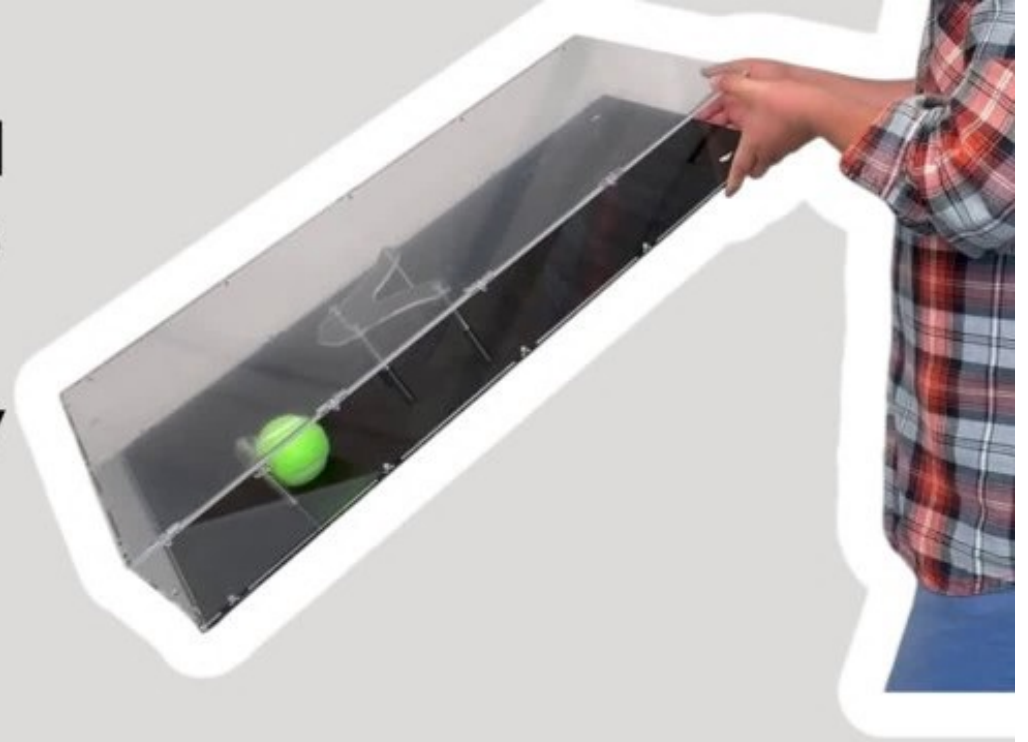

Place the lid on top to close the case.

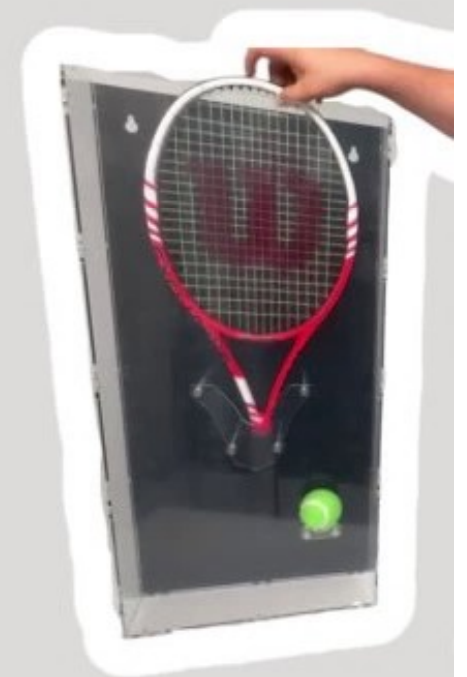

As the final step, remove the frontal layer of protective film from the front-panel.

